

SPECIFICATION:

Model	PST
<p>PST Installation diagram</p> <p>FEATURES:</p> <ul style="list-style-type: none"> Capacity 20kg to 10t Forced by threaded connection High accuracy Alloy steel, stainless steel <p>APPLICATION:</p> <ul style="list-style-type: none"> Testing machine Crane scale Packing scale 	

Wiring Diagram

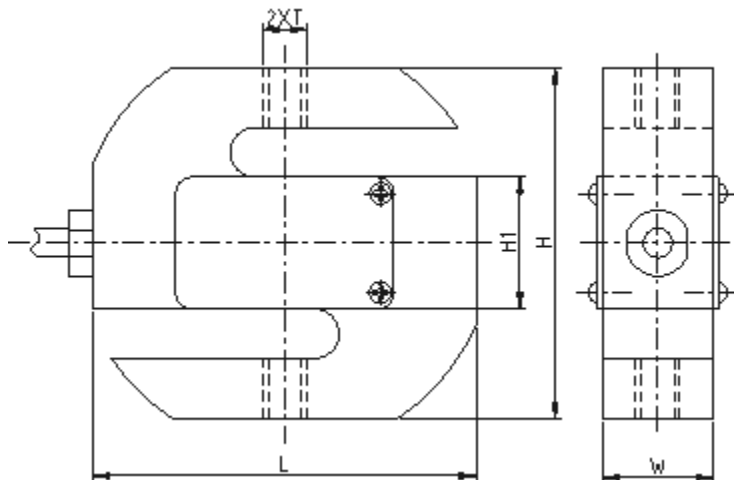
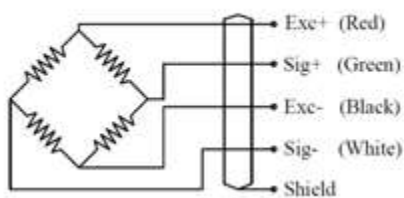

Outline Dimension:					
Rated capacity	L	W	H	H1	T
20kg~150kg	70	12	64	24	M8
200kg~500kg	70	20	64	24	M12
700kg~1t	70	25	64	24	M12
1.2t~5t	88	32	90	38	M20
7.5t	88	40	90	38	M24
10t	110	50	110	46	M30X2

SPECIFICATION:	
Rated capacity: 20kg to 10ton	Operating temperature range: -30 to +70°C
Rated output: 2.0±0.003mv/v, 1.8±0.003mv/v(10t)	Maximum safe overload; 150% OF R.C
Accuracy class: 0.03	Ultimate safe overload; 200% OF R.C
Non-linearity: ±0.03% F.S	Recommended Excitation; 10 to 12V DC
Hysteresis error: ±0.03% F.S	Maximum Excitation; 15V DC
Non-repeatability: ±0.02% F.S	Environment protection: IP65 (20kg~1t) IP67 (1.2t~10t)
Zero balance: ±1% F.S	Input impedance: 400±20Ω
Creep error(30minutes): ±0.03% F.S	Output impedance: 352±3Ω
Temperature effect on zero: ±0.02% F.S	Insulation resistance at 50V DC: ≥5000MΩ
Temperature effect on output: ±0.02% F.S	Material: nickel-plated alloy steel
Compensated temperature range: -10 to +40°C	Cable length: 2.6meter, diameter 5mm(20kg~1t); 3meter, diameter 6mm(1.2~7.5t); 3meter, diameter 5mm(10t)